

**OPTION # 1**

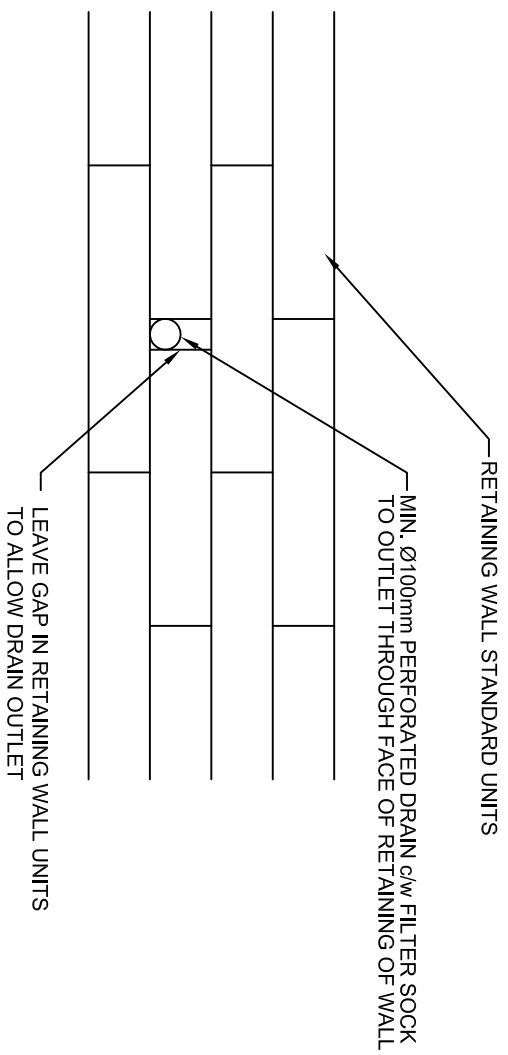

**OPTION # 2**

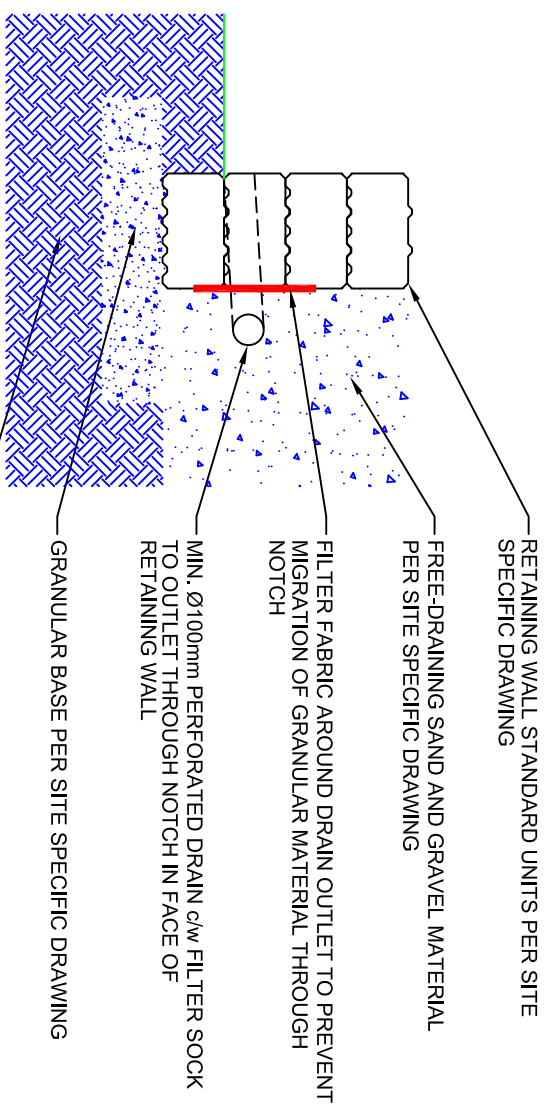
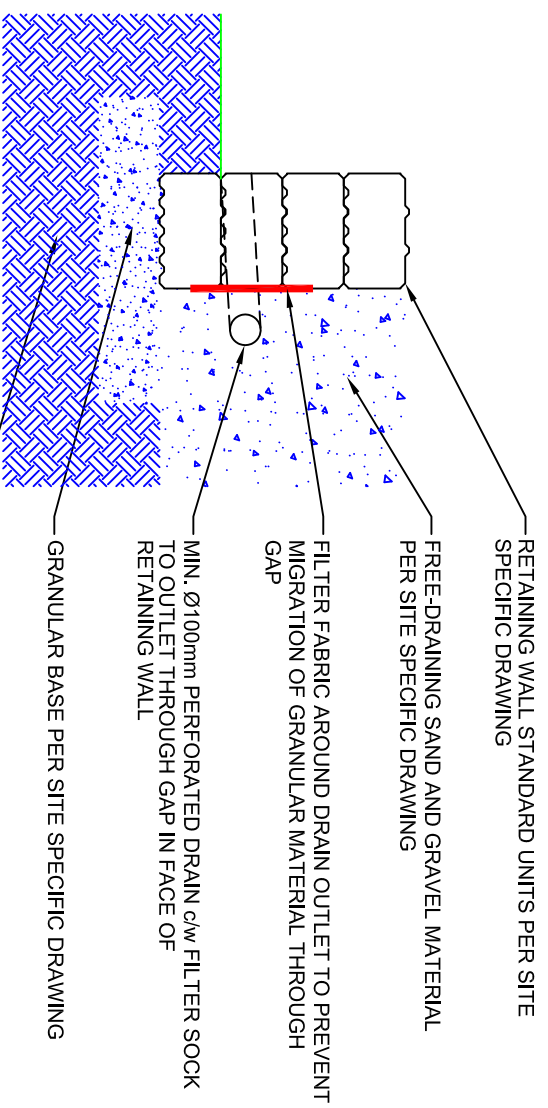

**DRAWING:**  
RETAINING WALL  
DRAIN OUTLET DETAIL

**PROJECT:**  
Navascape Products  
GRANDE WALL  
STANDARD ENGINEERING

**PROJECT ENGINEER:**

REV.	DATE	DESCRIPTION	BY
0	MAR 31 2014	ISSUED FOR CONSTRUCTION	DAD

**RETAINING WALL**



- GENERAL NOTES:**
- FOR EXCAVATION, BASE PREPARATION AND BACKFILLING, PLEASE REFER TO STANDARD ENGINEERING OR SITE SPECIFIC DESIGN.
  - MINIMUM Ø100mm PERFORATED DRAIN c/w FILTER SOCK TO OUTLET THROUGH FACE OF RETAINING WALL EVERY 15m OR CONNECT TO ON-SITE STORM SEWER SYSTEM. TO BE DETERMINED BY OTHERS PRIOR TO CONSTRUCTION OF RETAINING WALL.
  - A RODENT SCREEN TO COVER DRAIN OUTLET IS OPTIONAL. TO BE DETERMINED BY OTHERS.
  - UTILITIES TO BE INSTALLED IN CONJUNCTION WITH THE CONSTRUCTION OF THE RETAINING WALL
  - SAME PRINCIPAL APPLIES FOR BOTH GRAVITY AND GEORGRID REINFORCED WALLS.
  - ALL PRODUCT NAMES AND STYLIZED REPRESENTATIONS ARE TRADEMARKS OF PERMACON PRODUCTS. OR APPROVED FOR USE BY PERMACON PRODUCTS' COMPANIES.
  - THE APPLICABILITY OF THIS RETAINING WALL DETAIL MUST BE REVIEWED ON A SITE SPECIFIC BASIS BY A QUALIFIED PROFESSIONAL ENGINEER.

**DESIGN ENGINEER:**

**DRAWN BY:** DAD **CHD BY:** **DRAWING No.**

**DATE:** MARCH 31, 2014

**SCALE:** NOT TO SCALE

**FILE NAME:** DRAIN OUTLET.DWG

**DRAIN OUTLET  
DETAIL**